

MODE D'EMPLOI • HANDLEIDING • INSTRUCTIONS
BEDIENUNGSANLEITUNG • ISTRUZIONI PER L'USO • METODO DE EMPLEO • INSTRUÇÕES
INSTRUKTIONER • JUHISED • OHJEET • INSTRUKCIJAS • BRUKSANVISNING
INSTRUKTIONER • INSTRUKCIJOS • LEIÐBEININGAR

XPRESS'
OH



SYSTEM
1.2.3 SPRESSO



DESCRIPTION OF THE MACHINE:

- 1 - Cover
- 2 - Handle
- 3 - White light
- 4 - Small coffee button
- 5 - Large coffee button
- 6 - Tank lid
- 7 - Tank
- 8 - O/I switch
- 9 - Pod basket
- 10 - Strainer
- 11 - Stainer grid
- 12 - Coffee spout



1 - Raise handle no. 2

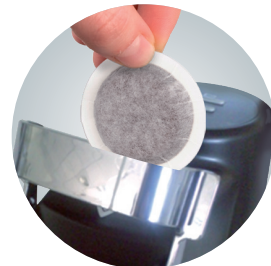

2 - Insert the pod



3 - Lower handle no. 2



4 - Select small coffee/ large coffee



SAFETY INSTRUCTIONS

- The machine is designed to prepare drinks according to these instructions.
- Do not use the machine for any purpose other than those intended.
- Do not switch the machine on without a dose.
- Do not use the machine without water.
- This machine meets CE standards; any repairs must be undertaken by your approved technical support centre.
- This machine was designed for indoor use only, for use at non-extreme temperatures.
- Protect your machine from the direct effects of the sun's rays, splashes of water and humidity.
- This machine is intended for domestic use only, plus similar uses such as:
 - Kitchenettes in shops, offices and other working environments.
 - Farms.
 - Hotel guests.
 - Guest houses and other residential environments such as bed & breakfast.
- The machine may be used by children over 8 and by people with reduced physical, sensual or mental capacity, or with lack of

experience and knowledge, provided that they are being supervised or have received instructions on how to use the machine and have understood inherent risks. Children must not play with the machine. Children under 8 must not carry out any maintenance or cleaning operations on the machine unsupervised.

- Place the machine and its power cable out of reach of children under 8.
- The manufacturer cannot accept any liability and the guarantee will be deemed null and void, in the event of commercial use, inappropriate use or mishandling, damage resulting from misuse, incorrect operation, repairs carried out by non-professionals, or failure to observe the instructions. Avoid the risks of fire and fatal electric shock.
- In case of emergency: unplug the machine from the power socket immediately.
- Only plug the machine into suitable power sockets, easily accessible and earthed. Make -sure that the power source voltage is the same as that shown on the label. Using an unsuitable power source will void the guarantee.
- The machine must only be plugged in once it has been set up.
- Do not pull the power cable against cutting edges, attach it to anything or let it hang loose.

- Keep the power cable away from heat and humidity.
- If the power cable is damaged, it must be replaced by the manufacturer, its After-sales Service or equally qualified people.
- If the power cable is damaged, do not use the machine.
- If an electrical extension lead is necessary, only use an earthed cable, whose conductor has a cross-section of at least 1.5 mm.
- To prevent dangerous damage, never place the machine on or next to hot surfaces such as radiators, cookers, ovens, gas stoves, naked flames or similar heat sources.
- Always place it on a horizontal surface which is stable and even. The surface must be resistant to heat and fluids such as: water, coffee, limescale remover, etc.
- Unplug the machine from the power socket when it is not going to be used for a prolonged period.
- Unplug the machine by pulling from the plug rather than the power cable so that you do not damage it.
- Before cleaning and maintaining your machine, unplug it from the power socket and let it cool down.
- Never touch the power cable with wet hands.
- Do not immerse the machine, either as a whole or in part, in water or any other liquids.
- Never place the machine or any part of it in a dishwasher.
- Together, electricity and water are dangerous and may cause fatal electric shocks.

- Do not open the machine. Internal voltage dangerous.
- Do not place anything in the openings. This could cause a fire or electric shock.
- Unplug the machine and let it cool down before cleaning it. To clean the waste collector, water reservoir, drainage plate, grille and percolator, use water and a mild detergent.
- Do not use the machine for any purpose other than those for which it is intended. Misusing the machine may cause injury.
- The surface of the element will remain hot for a certain length of time after use. Do not touch hot surfaces. Use the levers or buttons provided.
- The coffee maker shall not be placed in a cabinet when in use.

INTRODUCTION

The machine can prepare two sizes of coffee thanks to the two coffee buttons on the top.

The machine will automatically switch to standby after 20 minutes without use.

The coffee cannot flow continuously from the machine for more than 90 seconds. Beyond this period, the coffee cycle stops automatically.

REPAIRS

This device complies with EC standards. All repairs must be carried out by the authorised technical centre.

WATER

Fill your tank with fresh water whenever used (daily).

Using water with high mineral content (bottled water) is not recommended.

When the machine is switched on, during the heating phase the water boils temporarily and locally in the Thermoblock so that the required temperature is reached quickly. Don't be surprised if you hear noises.

PREPARING A COFFEE

The machine will only work with 123 SPRESSO® pods.

- 1 - Fill the tank with fresh water (no. 7).
- 2 - Connect the power cable.
- 3 - Switch the machine ON using the button on the back (no. 8).
- 4 - If the white light (no. 3) is flashing, the machine is heating.
- 5 - When the machine reaches the required temperature, the white light (no. 3) will stop flashing and stay ON steady.
- 6 - Open the coffee pod packaging, remove the foil lid and take out the pod.
- 7 - Insert the pod in the machine (raise handle no. 2 first).
- 8 - Then lower the handle (no. 2).
- 9 - Press the Small coffee (no. 4) or Large coffee (no. 5) button, as preferred.

The coffee cycle stops automatically at the end of the cycle or manually if the selected button is pressed. When the coffee is ready, raise the handle (no. 2), the used pod will fall into the used-pod tank (no. 9). The machine is then ready to make another coffee.

PROGRAMMING

The 2 coffee options (small or large) are pre-programmed by default (6 cl for a small coffee and 12 cl for a large coffee). You can change these volumes as follows:

- 1 - Start the machine (button no. 8). The white light must stay ON (the machine is at the right temperature, ready to make coffee).
- 2 - Raise the handle (no. 2) and insert a pod.
- 3 - Press and hold the «Small coffee» and «Large coffee» buttons (buttons no. 4 and no. 5) simultaneously for at least 5 seconds. The white light will then flash rapidly - the machine is in programming mode.
- 4 - Lower the handle (no. 2) and press the coffee option to be programmed (button no. 4 for small coffee and button no. 5 for large coffee).
- 5 - Once the required volume of coffee has been poured, press the same button again to stop serving and save the selected volume.
- 6 - The white light will then stay ON - the programming has been saved for the button.

ANOMALIES

I CAN'T MAKE COFFEE.

Check that the switch (no. 8) is set to I.

Check that the white light is ON steady. You cannot make coffee while the machine is heating, this is normal (the white light will flash slowly).

Check that the machine is not on standby. If so, press a coffee button (no. 4 or no. 5), or use the handle (no. 2,

open/close) to turn the machine ON. Wait until the machine reaches the required temperature (the white light stays ON steady).

Check that the handle (no. 2) is lowered.

THE POD FAILS TO EJECT

Check that the pod basket is empty.

Raise or lower the handle to eject the pod (several times if necessary).

NO COFFEE IS SERVED

Check the level of water in the tank.

THE WHITE LIGHT FAILS TO COME ON

Check that the machine is plugged in.

THE WHITE LIGHT FLASHES RAPIDLY (UNLESS PROGRAMMING MODE IS SELECTED)

Check that the water tank (no. 7) is in position.

CLEANING

Turn the coffee machine off and allow to cool in full before cleaning.

Clean the body of the coffee machine, the water tank (no. 7), the pod basket (no. 9) and the strainer with a sponge on a frequent and regular basis and leave to dry.

Reminder: Never immerse the machine in water to clean. Never place the machine or its accessories in a dishwasher.

DISMANTLING THE COFFEE UNIT

It may be necessary to clean the unit if a pod is trapped.

To clean the unit, stop and unplug the machine, set the machine switch (no. 8) to the O position, remove the machine cover (see photos) and release the unit by pulling the bolt towards you.

Rotate the unit anti-clockwise.

Reverse this procedure to refit the unit.

Important: if you forget to fit the bolt in the unit, you will not be able to close the cover, and the safety device will prevent you from refitting the cover (no. 1).

TO REMOVE THE MACHINE COVER:

Raise the handle (no. 2) to maximum, while pressing the two silver-plated handle discs simultaneously, pull the cover (no. 1) upwards



TO REMOVE THE COFFEE UNIT:



TO REFIT THE COFFEE UNIT:



TO REFIT THE MACHINE COVER:

Check that the coffee unit is in the open position (vertical lateral slots) and locked in (grey catch clipped upwards – see above procedure to refit the coffee unit).

Raise the handle (no. 2) to maximum, while pressing the two silver-plated handle discs simultaneously, bring the cover (no. 1) over the coffee unit, align the cover (no. 1) with the machine) and push the cover (no. 1) downwards until the two silver-plated discs are clipped in position. It is now impossible to raise the cover (no. 1) upwards.

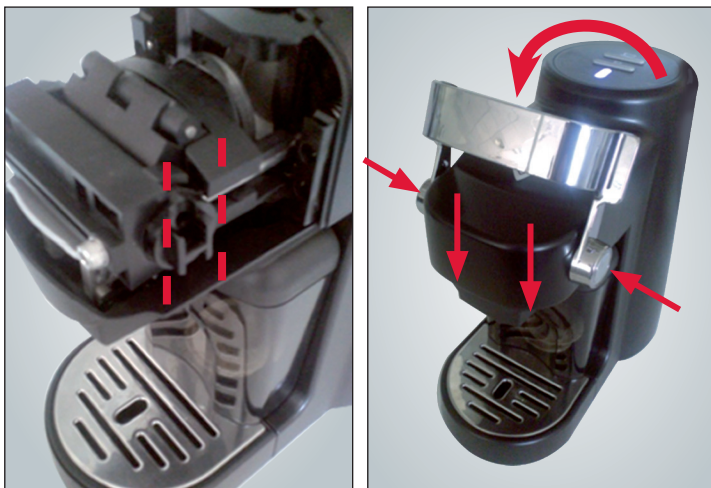

DESCALING THE MACHINE

The machine must be descaled every 6 months, if 2 to 4 coffees are served daily. You can purchase and use the scale remover kit which is especially designed for our “1,2,3 SPRESSO®” machines.

Simply contact your distributor.

TECHNICAL DATA

Automatic standby.

Colours: Black, White or Gun Metal Grey

Capacity: 1300 W

Voltage: 230 V

Weight: 3.0 kg

Pump: 16 bars

Tank: 1.2 l

Box dimensions: 400 x 196 x 345mm

The «1,2,3 SPRESSO®» machine benefits from a 12-month warranty from the date of purchase in the European Union.

Damage caused by scale is not covered by the warranty.



Environmentally-friendly recycling

Electrical and electronic equipment is sent to selective sorting sites.

Do not dispose of your electrical and electronic equipment at unsorted municipal tips, always use selective sorting sites.